

COMAL COUNTY CATTLEGUARD IMPROVEMENTS Comal County, Texas

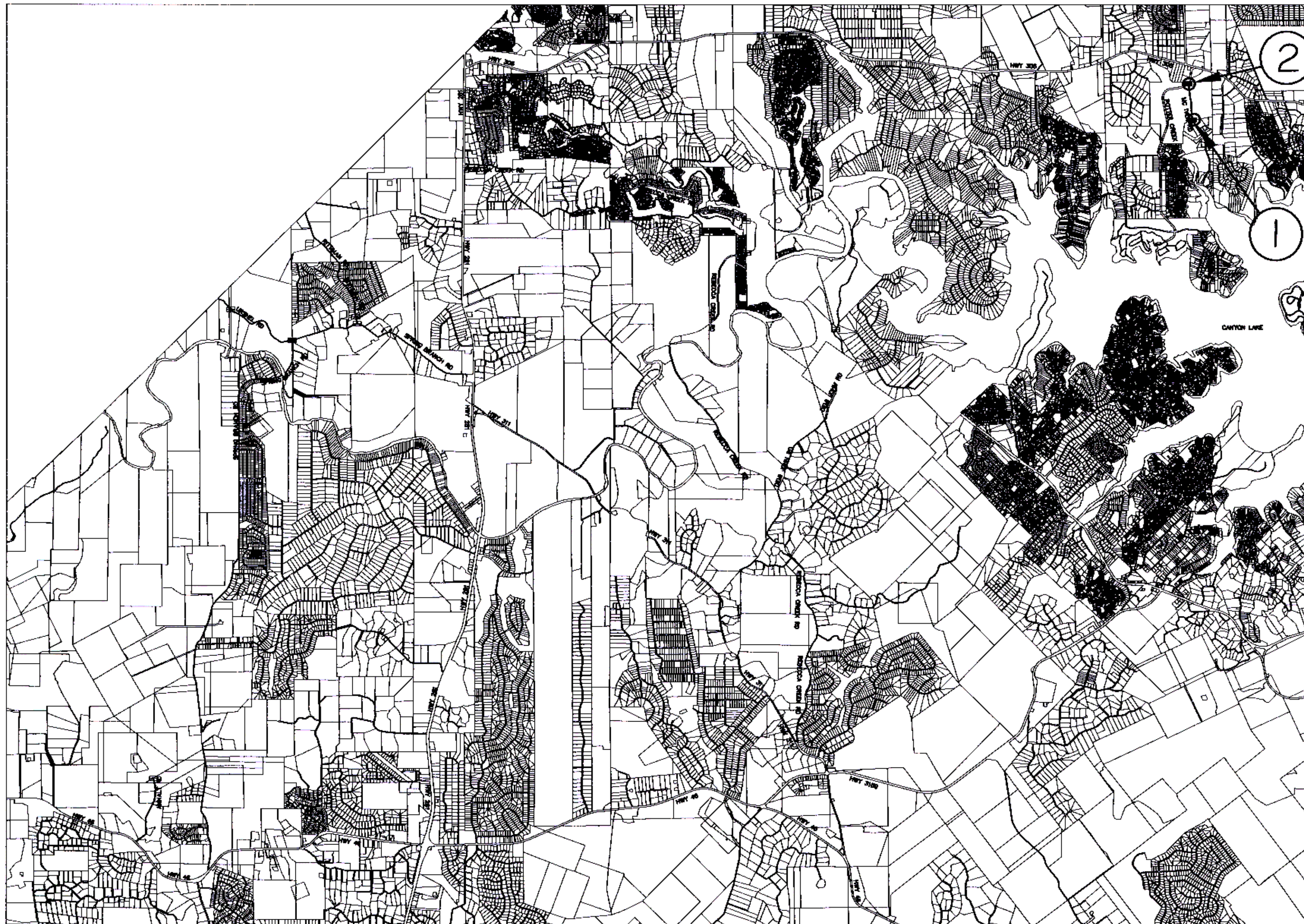

SHEET INDEX

1. COVER SHEET
2. EXISTING SITE CONDITIONS-CATTLEGUARD 1
3. EXISTING SITE CONDITIONS-CG1-PLAN/PROFILE
4. PROPOSED SITE CONDITIONS-CG1-PLAN/PROFILE
5. EXISTING SITE CONDITIONS - CATTLEGUARD 2
6. EXISTING SITE CONDITIONS-CG2-PLAN/PROFILE
7. PROPOSED SITE CONDITIONS-CG2-PLAN/PROFILE
8. CATTLEGUARD DETAILS
9. CONCRETE SPECIFICATIONS
10. GATE & ROAD DETAILS

NOTES:

1. UNDERGROUND UTILITIES MAY EXIST AT EACH SITE. CONTRACTOR TO CONTACT TEXAS 811 FOR UNDERGROUND UTILITY LOCATION AT LEAST 48 HOURS PRIOR TO EXCAVATION.
2. TRAFFIC & EMERGENCY VEHICLE ACCESS TO BE MAINTAINED AT ALL TIMES.
3. LIVESTOCK TO BE RESTRICTED AT ALL TIMES.
4. ALL WORK TO BE AS PER APPLICABLE COMAL COUNTY SPECIFICATIONS.

Kelly Kilber
 Kelly Kilber, PE Date 6/26/12



**ENGINEERING
GROUP**
 INCORPORATED
 Reg. No. F-1501
 100 E. San Antonio St., Suite 100
 San Marcos, TX. 78666
 (512) 353-3335

LOCATION MAP