

NOTE:
 MAIN LINE SHALL APPROXIMATELY BE PLACED
 IN MIDDLE OF EASEMENT.

COMAL COUNTY
 A-271, SUR-423
 A.L. HOLBROOK
 6.531 ACRES
 195 DAVID JONAS DRIVE

COMAL COUNTY
 A-271, SUR-421
 A.L. HOLBROOK
 14.065 ACRES
 145 DAVID JONAS DRIVE

90° BEND (6X6)
 USE CONCRETE THRUST BLOCKING
 AND RESTRAINT FITTINGS
 (SEE STANDARD DETAILS)

90° BEND (6X6)
 USE CONCRETE THRUST BLOCKING
 AND RESTRAINT FITTINGS
 (SEE STANDARD DETAILS)

PROPOSED 6" FIRE LINE
 (PVC, C-900, FIRE LINE)

TIE INTO EXISTING 4" FIRE LINE
 CUT AND CAP EXISTING 4" WATER LINE
 CURRENTLY TIED INTO 4" FIRE LINE

TIE INTO EXISTING 2" FIRE LINE
 CUT AND CAP EXISTING 2" WATER LINE
 CURRENTLY TIED INTO 2" FIRE LINE

TIE INTO EXISTING 6" FIRE LINE
 (MARKED BY YELLOW TRAFFIC POLE)

90° BEND (8X8)
 USE CONCRETE THRUST BLOCKING
 AND RESTRAINT FITTINGS
 (SEE STANDARD DETAILS)

TIE INTO EXISTING 6" LINE
 STA 1480+45
 81' RT

TIE INTO EXISTING 6" LINE

6X8 INCREASER

8" GATE VALVE

SEE EXHIBIT A

8" WATER MAIN

8X8X6 TEE

8X8X8 TEE

8" CAP

8" GATE VALVE

EXHIBIT A

8X6 REDUCER

E.O.P.

ROCK HILL TRL.

DAVID JONAS DR.

1480+00

R.O.W.



Comal County
 Road Department
 195 David Jonas Drive
 New Braunfels, TX 78132
 Phone: (830) 608-2090
 Fax: (830) 608-2009

COMAL COUNTY FIRE LINES
 PLAN VIEW

Date: 12/13/12
 Drawn by: RHB
 Checked by: THH

REVISIONS		SCALE: 1"=100'
No.	Date:	
1	5/02/13	

Sheet 5 of 12

HYDRANT AND
6" GATE VALVE
8" GATE VALVE
(3' NORTHEAST OF HYDRANT)

11.25° BEND (8X8)
USE CONCRETE THRUST BLOCKING
(SEE STANDARD DETAILS)
5' OFFSET FROM EASEMENT

CDMAL COUNTY
A-271, SUR-421
A.L.H.D. BOND
14.065 ACRES
145 DAVID JONAS DRIVE

HYDRANT AND
6" GATE VALVE

PROPOSED 8" WATER MAIN
(PVC, C-900)

EXISTING 12" WATER MAIN

TIE INTO EXISTING 6" LINE
6X8 INCREASER

PROPOSED 2" LINE WITH
A HOSE BIB EVERY 100'
(HOSE BIB SHALL BE
PLACED IN BELOW GRADE
CONCRETE BOX)

HOSE BIB AT
TERMINATION POINT
WITH 2" PVC CAP

CDMAL COUNTY
A-271, SUR-421
A.L.H.D. BOND
1.474 ACRES
281 RESOURCE DRIVE
325 RESOURCE DRIVE

JAVELINA CONSTRUCTION SOUTH, INC.
A-271, SUR-421
A.L.H.D. BOND
3.529 ACRES
4741 SM 48

CORNING
A-271, SUR-421
A.L.H.D. BOND
2.00 ACRES
4715 SM 48

MATCHLINE "A"

22.5° BEND (8X8)
USE CONCRETE THRUST BLOCKING
AND RESTRAINT FITTINGS
(SEE STANDARD DETAILS)
5' OFFSET FROM EASEMENT

NOTE:
ALL INSTALLED WATER LINES SHALL
BE A MINIMUM OF 5' FROM WATER
EASEMENTS.

BELOW GRADE CONCRETE BOX SHALL BE
OLDCASTLE PRECAST B03 BOX WITH A
REINFORCED CONCRETE LID, OR EQUAL.

NORTH

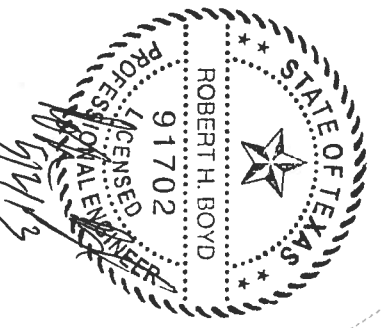

Comdal County
Road Department
195 David Jonas Drive
New Braunfels, TX 78132
Phone: (830) 608-2090
Fax: (830) 608-2009

CDMAL COUNTY FIRE LINES
PLAN VIEW

Date: 3/15/12
Drawn by: RHB
Checked by: THH

REVISIONS		SCALE: 1"=100'
No.	Date:	
1	5/02/13	
		Sheet 6 of 12

NORTH

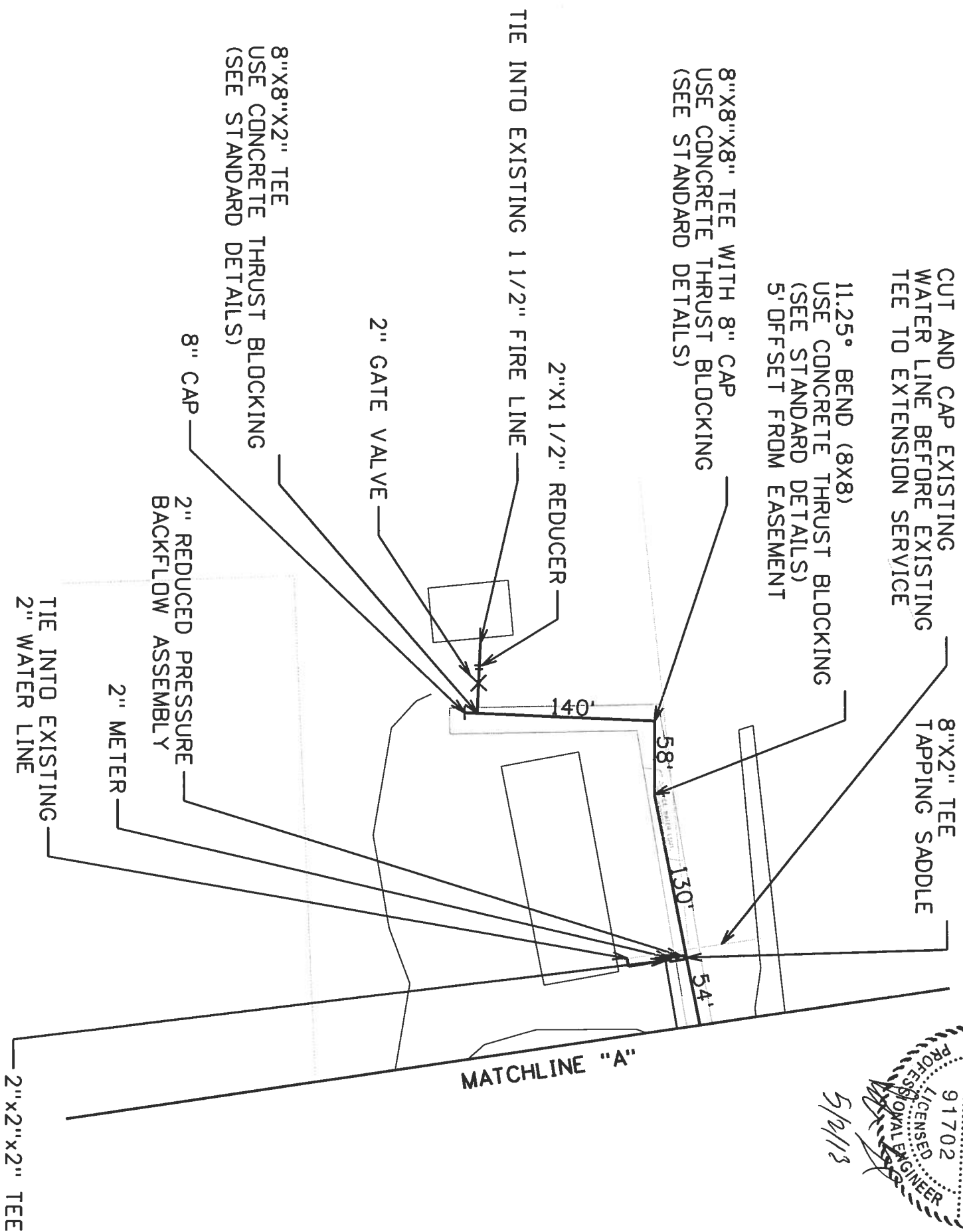

Comal County
Road Department
195 David Jones Drive
New Braunfels, TX 78132
Phone: (830) 608-2090
Fax: (830) 608-2009

COMAL COUNTY FIRE LINES
PLAN VIEW

Date: 3/15/12
Drawn by: RHB
Checked by: THH

REVISIONS	
No.	Date:
1	5/2/13

SCALE: 1"=100'
Sheet 7 of 12